

*If I don't dream, who  
will do it for me?*

John L. Biach  
1905-1973

# Expanding Horizons

Biach Industries, Inc. Quarterly Newsletter Vol. 6 No.1 – November 2003

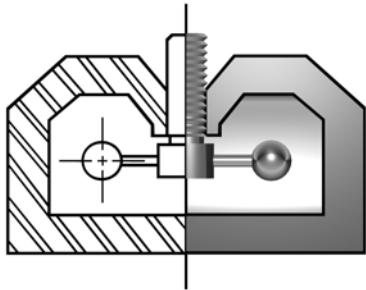

**Team Industrial** ordered additional Crimping Tools from Biach for use on hydrogen reformer inlet and outlet pigtail lines. **Cryovac** orders custom stud tensioners for its production facility. **Flowserve** – through Astute Technology – orders another custom hydraulic coupling tool for use on reactor coolant pump shafts during maintenance work.

**Karl Koch Erecting Company** has purchased Biach tensioners for use on a rehabilitation project on the Williamsburg Bridge in New York City. Biach has worked closely with engineers at Koch for bridge refurbishment projects at several of New York City's major bridges.



Picture depicts Koch Erecting Co. performing bridge refurbishment on the Williamsburg Bridge using a Biach tensioner.

**GE Medical** purchased a new customized stud tensioning system for use in the assembly of GE's MRI machines. The system includes eight specially designed stud tensioners and a sophisticated electric pumping system. The pumping system features two separate pressure circuits with closed loop pressure control, pre-set target pressure combinations, but with the ability to reach any specified pressure, and the ability to lock in separately any pressure in each of the eight stud tensioners.



**Boeing** orders another custom stud tensioner for use on the Space Shuttle.

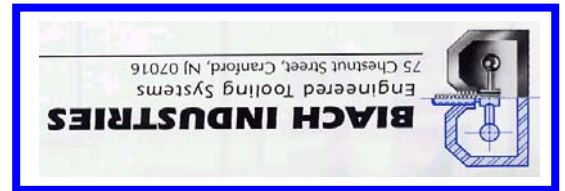

## *Biach Launches New Products:*

	1	2	3	4	
Elon:	.055	.053	.054	.055	
Nut:	■	■	■	■	
Stud:	1	11	23	31	
	TARGET PSI		ACT. PSI		
	99999		-99999		
	-100	-20	Release	+20	+100



**EMS – Elongation Monitoring System**  
 Gives direct elongation readings to pump operator to eliminate need for trim passes.

**SEMS III**  
 Data acquisition unit plugs into SEMS-HC for precise, immediate documentation of elongation readings.

*Southern California Edison* ordered Biach’s new EMS feature for its RPV stud tensioning system at San Onofre Nuclear Generating Station. The EMS feature can be retrofitted to QD, QA and QD-H model tensioners. This saves the site critical path time from unnecessary moves of the tensioners during the bolt up process.

Biach completes a major project for the ANGRA plant in Brazil: Equipment included a spare RPV stud tensioner, EPN pumping system with new communication boxes and test block assemblies.

**FIELD SERVICE NEWS.....**

Biach Tech Reps were busy this summer and fall performing maintenance overhauls and outage support at:

* <b>LaSalle</b>	* <b>Salem</b>	* <b>VC Summer</b>
* <b>Vogtle</b>	* <b>Seabrook</b>	* <b>Dresden</b>
* <b>Watts Bar</b>	* <b>Millstone</b>	* <b>Quad Cities</b>
* <b>Columbia</b>	* <b>Byron</b>	* <b>Sequoyah</b>
* <b>Clinton</b>	* <b>Braidwood</b>	* <b>Comanche Peak</b>